

# BK7 Cut-Rod Lenses

## LENS DRAWING

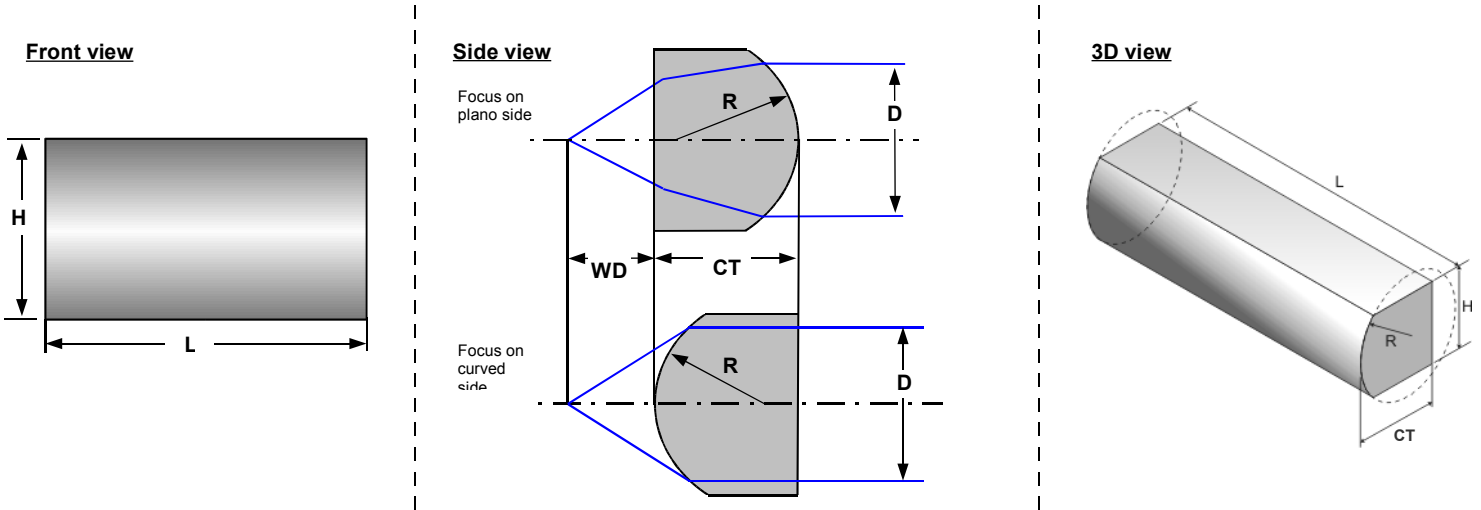

## LENS DESIGN INFORMATIONS

Ordering Code CYL_CRO_BK7_R_H_CT_L_AR(λ1-λ2)	Dimensions <sup>1</sup>			
	R	H	CT	L
Material: BK7				

<sup>1</sup>. All units are mm

### Refractive index vs. λ

λ (nm)	532	633	810	1064	1550
n	1.5195	1.5151	1.5106	1.5066	1.5006

### Useful formulae

$$\Phi = 2 R$$

$$EFL = \frac{R}{(n-1)}$$

Focus on curved side:  $WD = EFL$

Focus on plano side:  $WD = EFL - CT / n$

$$D = 2 \cdot EFL \cdot NA$$

Presently, most of our productions of cut-rod lenses are custom order.

Use the ordering code on the right to place an order or contact us for more information.

E-mail: [sales@doriclenses.com](mailto:sales@doriclenses.com)

Ordering code: CYL\_CRO\_BK7\_R\_H\_CT\_L\_AR(λ1-λ2)

- CYL: Cylindrical lenses
- CRO: Cut-rod lens code
- BK7: Material: BK7
- R: Rod radius (mm)
- H: Lens height (mm)
- CT: Central thickness (mm)
- L: Lens length (mm)
- AR(λ<sub>1</sub>-λ<sub>2</sub>): Anti-reflection coating wavelength range (nm)

### Legend

EFL: Effective focal length

Φ: Rod diameter

L: Rod length

NA: Numerical aperture

R: Rod radius

n: Refractive index

WD: Working distance

H: Lens height

AR(λ<sub>1</sub> - λ<sub>2</sub>): Anti-reflection coating wavelength range

D: Beam diameter

CT: Central thickness

